



Rometec s.r.l.

Via Alessandro Minuziano, 87-89 , 00128 Roma
 Tel. 065061635 – Fax 065061542
 Sito web: www.rometec.it – email: info@rometec.it
 P. IVA 04120621000 - CCIAA RM 736916
 Reg. Soc. Tribunale RM 9229/91 - Cap. soc. 46'482,00 €



LZB-VA30S, LZB-SA30S, LZB-FA30S Rotameter

SR LZB-VA30S, SA30S, FA30S type flowmeter shell is made of polished SS304 stainless steel material, beautiful, practical and lightweight. The interface connections include: female thread, lap joint flange, and sanitary clamp three specifications.



Drawing and dimensions

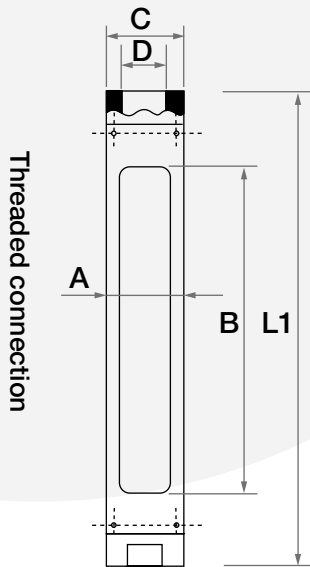

VA30S

Nominal Diameter DN (mm)	Window Size AxB (mm)	VA30S Hose Connection		
		L1 (mm)	C (mm)	D
15	26x236	344	φ 38	BSP 1/2"
25	34x226	348	φ 55	BSP 1"
40	44x226	370	φ 70	BSP 1-1/2"
50	60x216	380	φ 90	BSP 2"

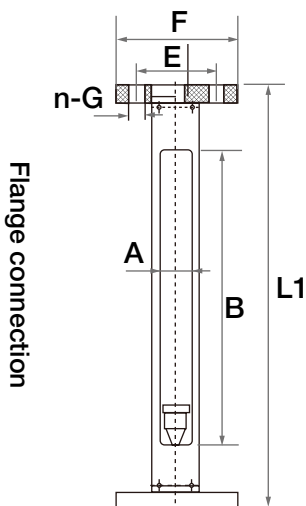

FA30S

Nominal Diameter DN (mm)	Window size AxB (mm)	FA30S flange connection			
		L2 (mm)	E (mm)	F (mm)	n-G (mm)
15	26x236	348	φ 65	φ 95	4- φ 14
25	34x226	348	φ 85	φ 115	4- φ 14
40	44x226	370	φ 110	φ 145	4- φ 18
50	60x216	370	φ 125	φ 160	4- φ 18



Romotec s.r.l.

Via Alessandro Minuziano, 87-89 , 00128 Roma

Tel. 065061635 – Fax 065061542

Sito web: www.romotec.it – email: info@romotec.it

P. IVA 04120621000 - CCIAA RM 736916

Reg. Soc. Tribunale RM 9229/91 - Cap. soc. 46'482,00 €

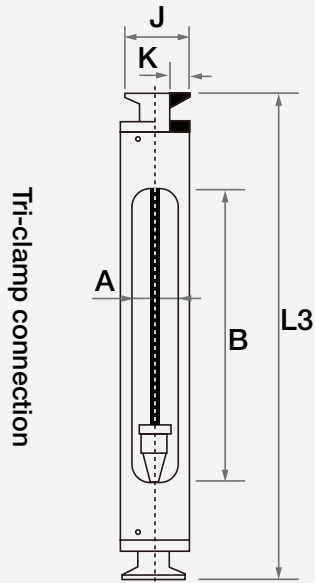

Nominal Diameter DN (mm)	Window Size AxB (mm)	WA30S Sanitary Clamp Installation End		
		L3 (mm)	J (mm)	K
15	26x236	376	50.5	3/4"
25	34x226	376	50.5	1"
40	44x226	376	50.5	1-1/2"
50	60x216	376	64	2"

Technical parameters

Model	Nominal Diameter DN (mm)	Measurement Range		Accuracy (±%)	Operating Temperature (°C)	Operating Pressure (MPa)
		20 °C water (L/h)	20 °C Air: 101325 Pa (m ³ /h)			
SR LZB-VA30S-15 SR LZB-FA30S-15 SR LZB-WA30S-15	15	4-40, 6.3-63, 10-100, 12-120, 16-160, 20-200, 25-250, 30-300, 36-360, 40-400, 46-460, 63-630, 65-650, 75-750	0.12-1.2, 0.2-2, 0.3-3, 0.4-4, 0.5-5, 0.6-6, 0.8-8, 0.9-9, 1.2-12, 2-20	±1.5	Standard type: -20 °C to +60 °C corrosion-resistant type: -20 °C to +120 °C	≤1.0
SR LZB-VA30S-25 SR LZB-FA30S-25 SR LZB-WA30S-25	25	40-400, 50-500, 63-630, 80-800, 100-1000, 120-1200, 160-1600, 200-2000, 250-2500, 300-3000	1.6-16, 2-20, 2.5-25, 3-30, 4-40, 5-50, 6-60			≤1.0
SR LZB-VA30S-40 SR LZB-FA30S-40 SR LZB-WA30S-40	40	160-1600, 200-2000, 250-2500, 300-3000, 400-4000, 500-5000, 600-6000	5-50, 6-60, 8-80, 9-90, 12-120			≤0.9
SR LZB-VA30S-50 SR LZB-FA30S-50 SR LZB-WA30S-50	50	250-2500, 300-3000, 400-4000, 500-5000, 630-6300, 800-8000, 1000-10000, 1500-15000, 4000-16000	10-100, 12-120, 16-160, 20-200, 30-300			≤0.7